

Sydney Motorway Network

Your guide to using the



Translating and Interpreting Service

If you need an interpreter, please call the Translating and Interpreting Service (TIS National) on **131 450** and ask them to telephone Roads and Maritime Services on 1300 862 844.

Arabic
إذا كنتم بحاجة إلى مترجم، الرجاء الاتصال بخدمة الترجمة الوطنية والشعبية (TIS National) على الرقم **131 450** والطلب منه الاتصال بخدمات Roads and Maritime Services على الرقم 1300 862 844.

Cantonese
若你需要口譯員，請致電 **131 450** 聯絡翻譯和口譯服務署 (TIS National) 要求他們致電 1300 862 844 聯絡 Roads and Maritime Services。

Mandarin
如果你需要口译员，请致电 **131 450** 联系翻译和口译服务署 (TIS National)，要求他们致电 1300 862 844 联系 Roads and Maritime Services。

Greek
Αν χρειάζεστε διερμηνέα, παρακαλείσθε να τηλεφωνήσετε στην Υπηρεσία Μετάφρασης και Διερμηνείας (Εθνική Υπηρεσία ΤΙΣ) στο **131 450** και ζητήστε να τηλεφωνήσουν Roads and Maritime Services στο 1300 862 844.

Italian
Se desiderate l'assistenza di un interprete, prego telefonare al Servizio Interpreti e Traduttori (TIS National) al **131 450** chiedendo di contattare Roads and Maritime Services al 1300 862 844.

Korean
통역사가 필요하시면 번역통역서비스 (TIS National)에 **131 450** 으로 연락하여 이들에게 1300 862 844 번으로 Roads and Maritime Services 에 전화하도록 요청하십시오.

Vietnamese
Nếu cần thông ngôn viên, xin quý vị gọi cho Dịch Vụ Thông Phiên Dịch (TIS Toàn Quốc) qua số **131 450** và nhờ họ gọi cho Roads and Maritime Services qua số 1300 862 844.

Roads and Maritime Services

This publication is intended as a guide to Sydney Motorway Network. While every effort has been made to ensure its accuracy, it should not be used in place of a current street directory.

To get an up-to-date list of toll charges or to calculate your toll visit: rms.nsw.gov.au or sydnymotorways.com

For further enquiries:

www.rms.nsw.gov.au

132 213 (8.30am to 5pm Monday-Friday and 8.30am to noon Saturday)

Cat No. 45094812
May 2014
RM514.166

Printed on recycled paper

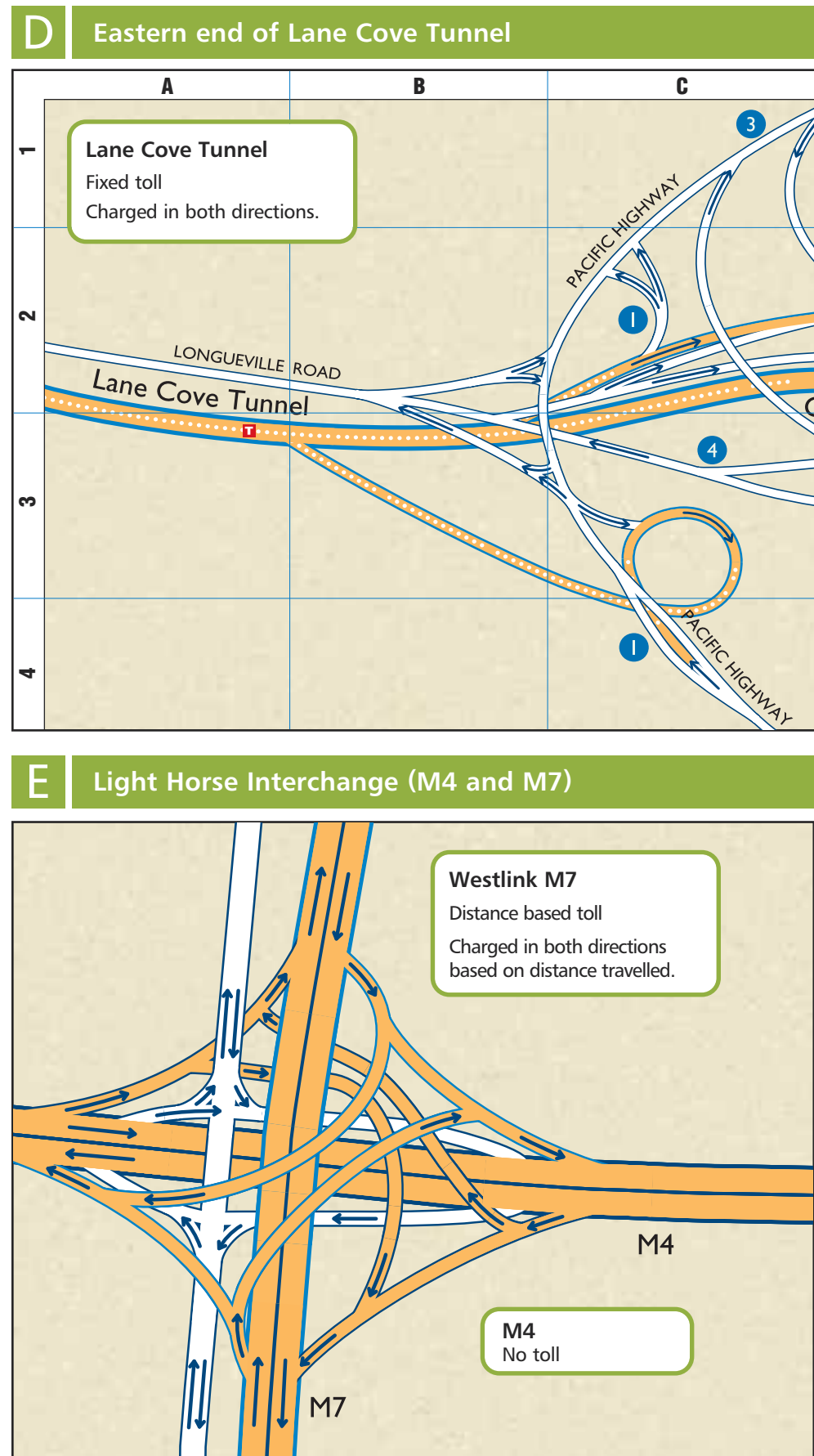
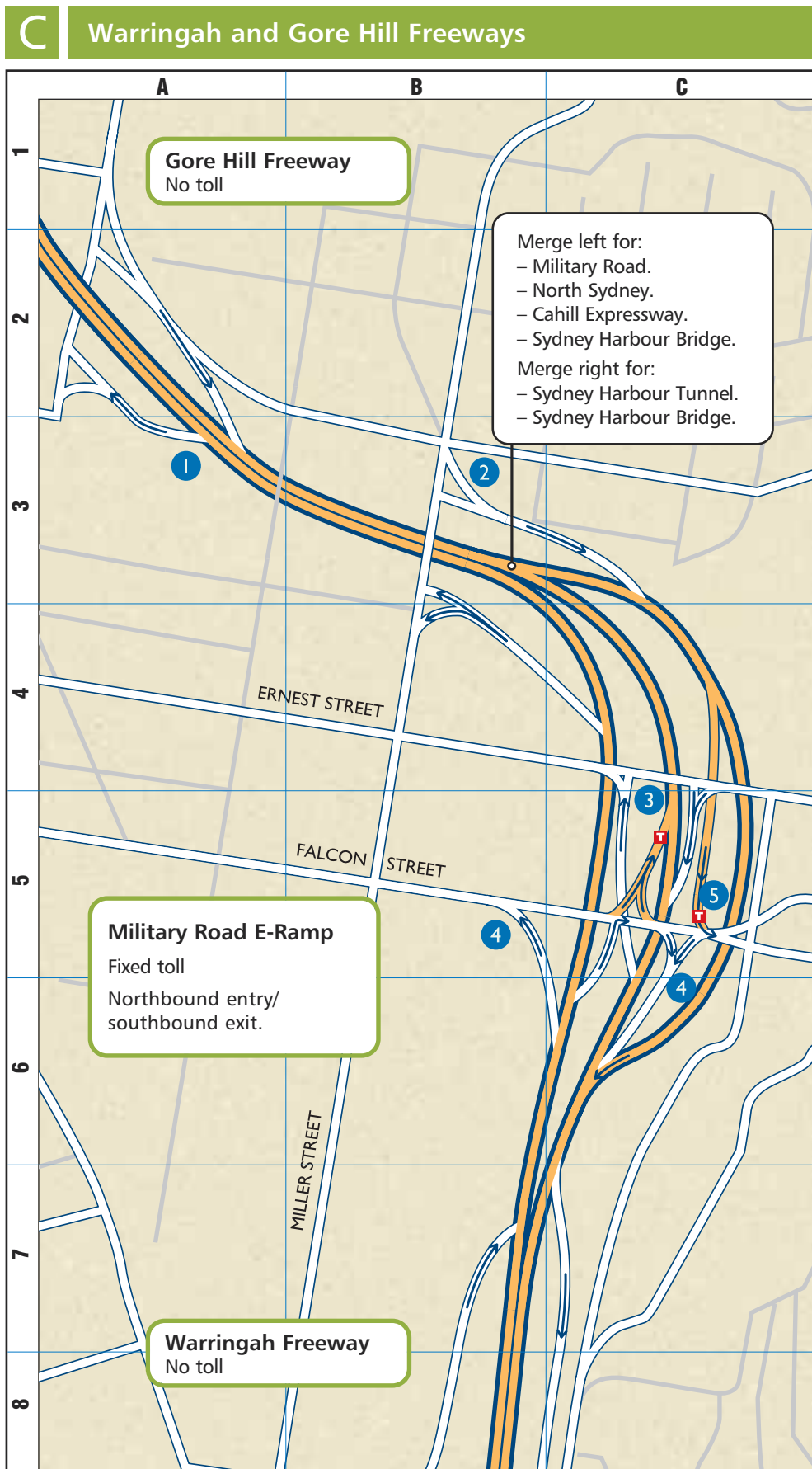
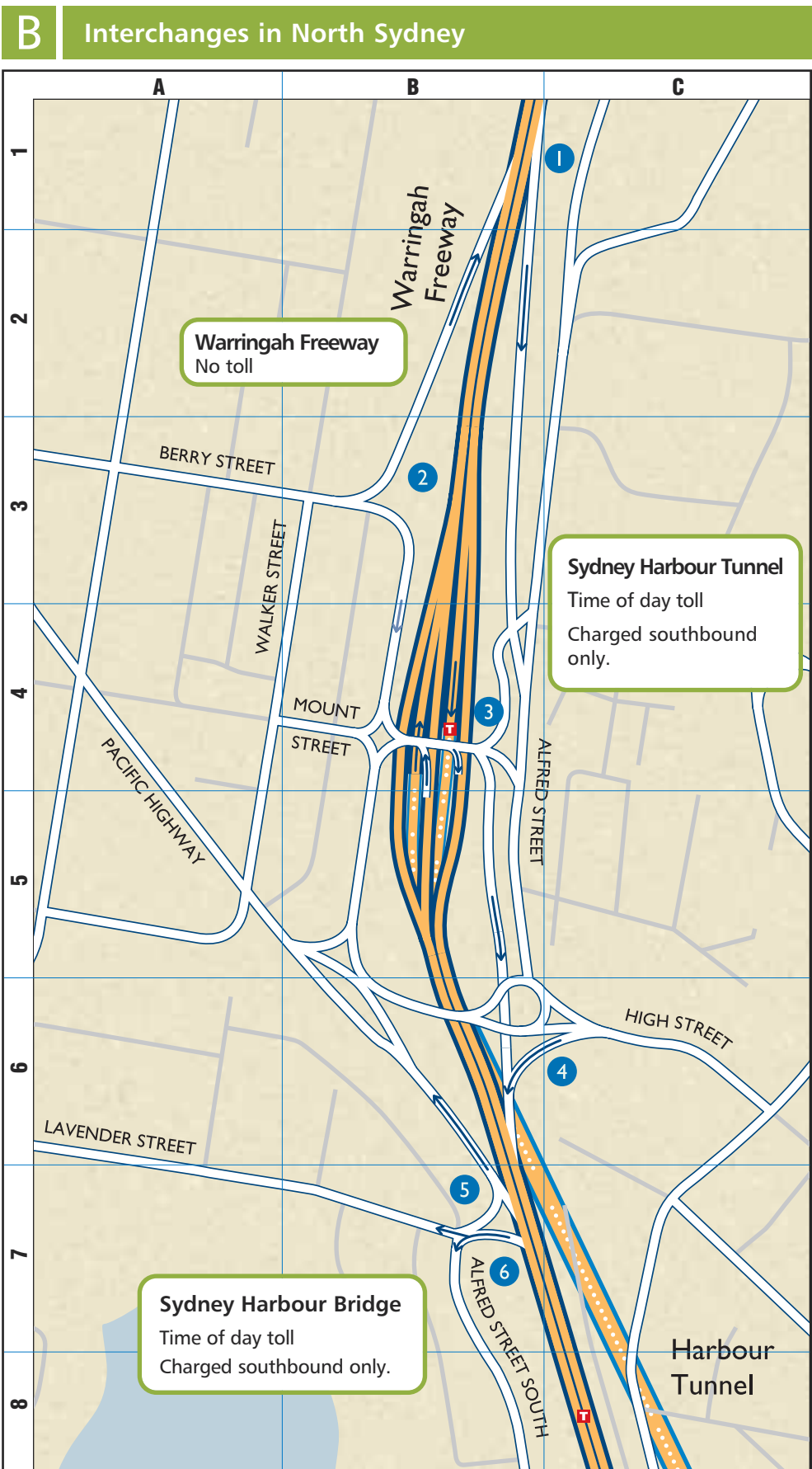
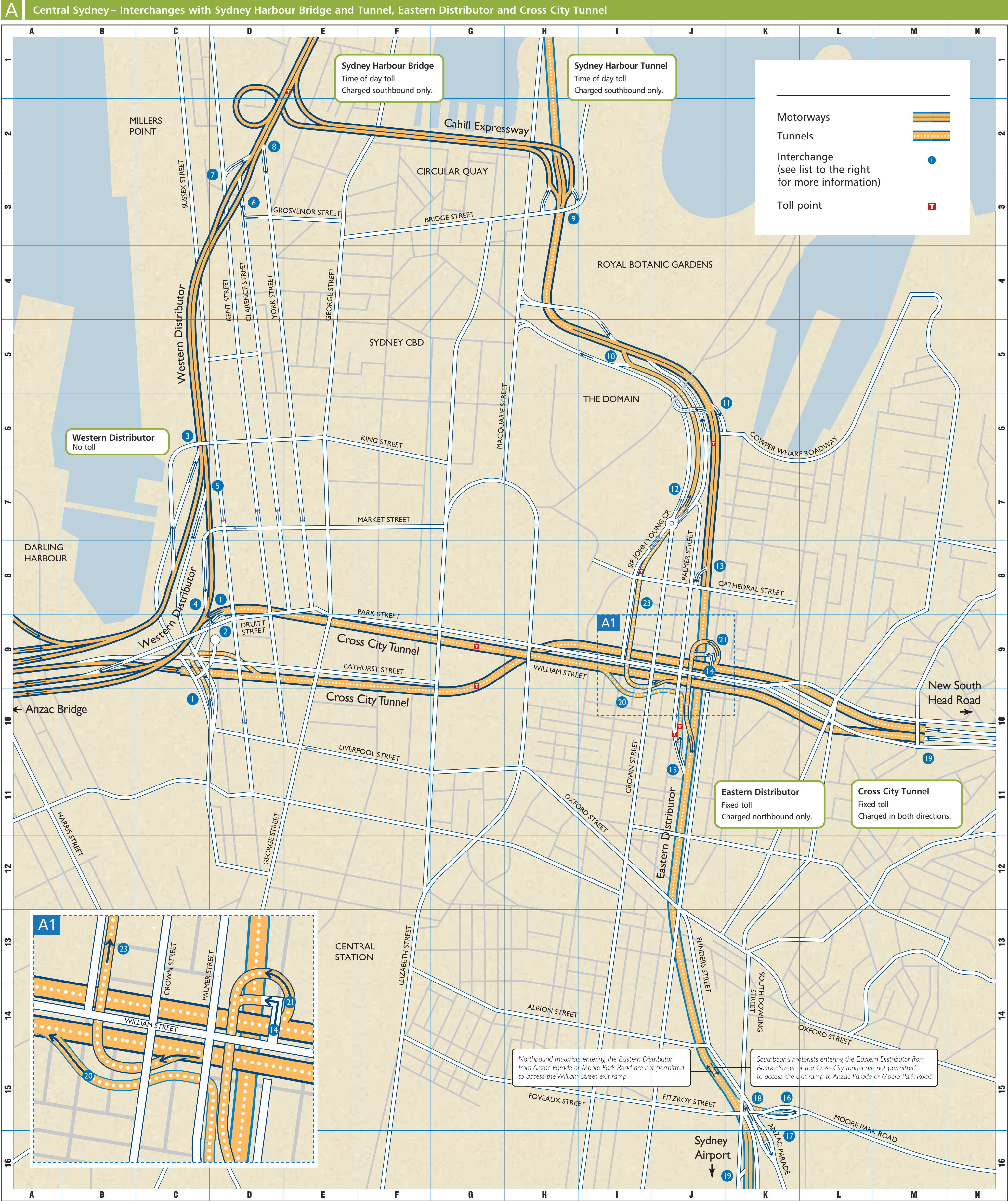

Interchange	Grid
Cross City Tunnel	
1 Harbour St (eastbound entry and westbound exit only)	C 8, C 10
2 New South Head Rd (westbound entry and eastbound exit only)	M 10
3 Cahill Expressway (northbound exit only)	I 9
Western Distributor	
No toll.	
4 Druiett St (westbound entry only)	C 9
5 King St (eastbound exit only)	C 6
6 Market St (westbound entry only)	C 8
7 Harbour St (southbound exit only)	C 7
Sydney Harbour Bridge	
8 Clarence St and Grosvenor St (northbound entry only)	D 3
9 Kent St (northbound entry only)	D 2
10 Grosvenor St/York St (southbound exit only)	D 2
Cahill Expressway	
No toll.	
11 Bridge St (northbound entry and southbound exit only)	H 3
12 Macquarie St (southbound entry and northbound exit only)	I 5
13 Cowper Wharf Rd (northbound entry and southbound exit only)	J 6
14 Sir John Young Cres (northbound entry only)	J 7
15 Cathedral St (southbound exit only)	J 8
Eastern Distributor	
16 William St (southbound entry only)	J 9
17 William St (northbound exit only)	J 10
18 Moore Park Rd (eastbound exit only)	K 15
19 Anzac Pde (southbound exit only)	K 16
20 Anzac Pde and Moore Park Rd (northbound entry only)	K 15
21 South Dowling St (northbound entry only)	K 16
22 Cross City Tunnel (westbound exit only)	I 10
23 Cross City Tunnel (southbound entry only)	J 9
Warringah Freeway	
No toll.	
24 Alfred St North (southbound exit only)	B 1
25 Berry St (northbound entry only)	B 3
26 Mount St (southbound entry and northbound exit only)	B 4
27 High St (Southbound entry only)	C 6
28 Pacific Hwy (northbound exit only)	B 7
29 Lavender St (northbound exit only)	B 7
Gore Hill Freeway	
No toll.	
30 Brook St (northbound exit and southbound entry only)	A 3
31 Miller St (northbound exit and southbound entry only)	B 3
32 Ernest St (northbound exit and southbound entry only)	C 4
33 Falcon St (northbound exit and southbound entry only. Southbound entry use left lane for Sydney Harbour Bridge, Kirribilli and North Sydney or right lane for Sydney Harbour Bridge and Sydney Harbour Tunnel)	B 5, C 5
Military Road E-Ramp	
34 Falcon St/Military Rd (southbound exit and northbound entry only)	C 5
Lane Cove Tunnel	
35 Pacific Hwy (eastbound exit and westbound entry only)	C 2, C 4
Gore Hill Freeway	
No toll.	
36 Reserve Rd	E 2, E 3
37 Pacific Hwy (northbound exit and eastbound entry only)	C 1, D 3
38 Longueville Rd (westbound exit and eastbound entry only)	C 3, D 4

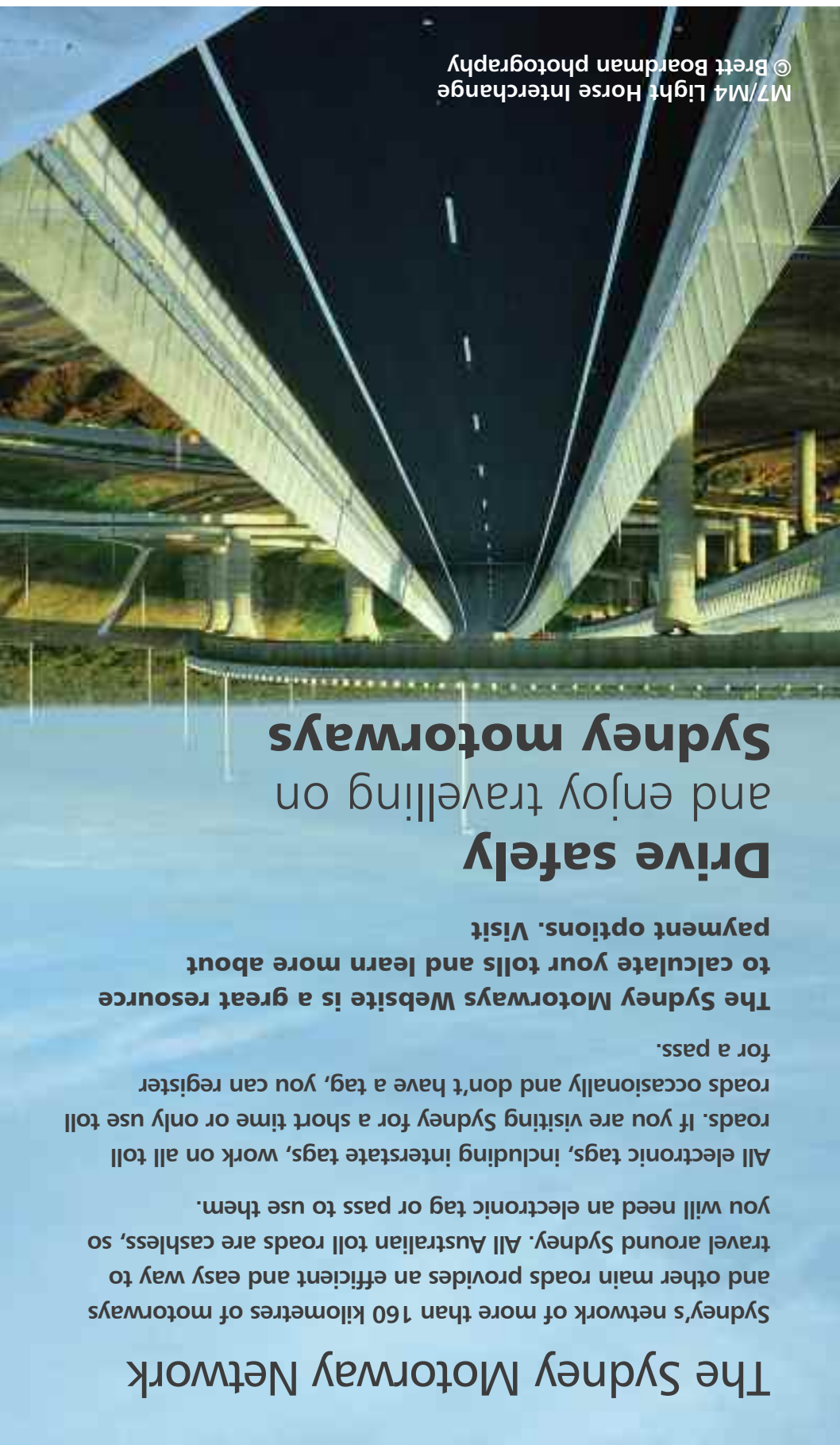

M7/M4 Light Horse Interchange
© Brett Boardman photography

The Sydney Motorway Network
Sydney's network of more than 160 kilometres of motorways and other main roads provides an efficient and easy way to travel around Sydney. All Australian toll roads are cashless, so you will need an electronic tag or pass to use them.
All electronic tags, including Interstate tags, work on all toll roads. If you are visiting Sydney for a short time or only use toll roads occasionally and don't have a tag, you can register for a pass.
The Sydney Motorways Website is a great resource to calculate your tolls and learn more about payment options. Visit sydnymotorways.com and enjoy travelling on Sydney motorways

